

# Highland Archives

Inverness  
Caithness  
Lochaber  
Skye & Lochalsh



Tasglann na  
Gàidhealtachd



*'Archives reveal the past, explain the present, and guide the future. They are essential to good administration, to the democratic and legal rights of the citizen, and to a proper understanding of both the past and the present'.*

**Scottish National Archives Policy, 1998.**

## **WHAT ARE ARCHIVES?**

### **DÈ THA ANN AN TASGLANNAN?**

Archives are the records of official bodies, businesses, societies and individuals which have been identified as worthy of permanent preservation. Since they are a unique record of our past, archives need to be preserved in secure, environmentally controlled conditions from where they may be made available to the public for research.

[www.highlandarchives.org.uk](http://www.highlandarchives.org.uk)

## **HIGHLAND ARCHIVE CENTRE**

Bught Road, Inverness IV3 5SS

**Telephone:** 01463 256444

**Email:** [archives@highlifehighland.com](mailto:archives@highlifehighland.com)

## **CAITHNESS ARCHIVE CENTRE**

Wick Library, Sinclair Terrace, Wick,  
Caithness KW1 5AB

**Telephone:** 01955 606432

**Email:** [north.highlandarchive@highlifehighland.com](mailto:north.highlandarchive@highlifehighland.com)

## **LOCHABER ARCHIVE CENTRE**

West Highland College, An Aird, Fort William,  
Inverness-shire PH33 6FF

**Telephone:** 01397 701942/700946

**Email:** [lochaber.archives@highlifehighland.com](mailto:lochaber.archives@highlifehighland.com)

## **SKYE AND LOCHALSH ARCHIVE CENTRE**

Elgin Hostel, Dunvegan Road, Portree,  
Isle of Skye IV51 9EE

**Telephone:** 01478 614078

**Email:** [skyeandlochalsk.archives@highlifehighland.com](mailto:skyeandlochalsk.archives@highlifehighland.com)

## **HIGHLAND ARCHIVE SERVICE**

### **SEIRBHEIS TASGLAINN NA GÀIDHEALTACHD**

The Archive Service is responsible for locating, preserving and making accessible archives relating to all aspects of the history of the geographical area of The Highland Council.

The archive service is part of High Life Highland. It enables High Life Highland and The Highland Council to meet their statutory obligations to make proper arrangements for the management of their records.

**Public Records (Scotland) Act 2011.**

## **HOW TO USE THIS BOOKLET**

### **MAR A CHLEACHDAR AN LEABHRAN SEO**

General information..... Pages 2 - 5

Then this booklet is divided into four sections, showing what is available at each of the Archive Service locations throughout the Highlands, each colour coded as follows:

#### Section One:

### **HIGHLAND ARCHIVE CENTRE**

Pages 6 - 9

Family History Centre.....Pages 10 - 11

#### Section Two:

### **CAITHNESS ARCHIVE CENTRE**

Pages 12 - 15

#### Section Three:

### **LOCHABER ARCHIVE CENTRE**

Pages 16 - 19

#### Section Four:

### **SKYE AND LOCHALSH ARCHIVE CENTRE**

Pages 20 - 23



*H. Thomson pinxt*

*Inverness.*

*P. Mayall sculpit*

Archives are used for a wide variety of purposes such as to research the history of a Highland community, or of a particular house or property, to research family history, to assist in legal and official enquiries, and for research into many aspects of the social, economic and political history of the Highlands.





Detailed catalogues of many of the collections held by the Archive Service are available for consultation in the searchrooms. Online access to SCAN (the Scottish Archives Network) and other archival websites, is also available in the searchrooms.

Photocopies and photographs of archives can be obtained, depending on copyright and on the physical condition of the document (a list of current charges is available).



7

| SUCCESSIVE NUMBER (OR NUMBER OF PERMISSION) | DATE OF EMIGRATION OR RE-EMIGRATION |           | NAME IN FULL CHRISTIAN AND SURNAME. |
|---|-------------------------------------|-----------|-------------------------------------|
|   | Year                                | Month Day |                                     |
| 152   | 91                                  | 10 30     | Bremner David                       |
| 153   | 91                                  | 10 30     | Murray Allroy                       |
| 154   | 91                                  | 11 18     | Jamieson Robt                       |
| 155   | 91                                  | 11 30     | Bremner Thos                        |
| 156   | 92                                  | 1 25      | Johnson Jas                         |
| 157   | 92                                  | 2 3       | Murray Jas                          |
| 158   | 92                                  | 2 8       | Bella Wm                            |
| 159   | 92                                  | 2 8       | McKenzie                            |
| 160   | 92                                  | 2 9       | Sharp                               |
| 161   | 92                                  | 2 9       | Wilson                              |
| 162   | 92                                  | 2 11      | Ross                                |
| 163   | 92                                  | 3 7       | Murray                              |
| 164   | 92                                  | 4 4       | Wm                                  |
| 165   | 92                                  | 4 5       | Ho                                  |
| 166   | 92                                  | 5 20      | W                                   |
| 167   | 92                                  | 4 11      |                                     |
| 168   | 92                                  | 5 3       |                                     |
| 169   | 92                                  | 5 9       |                                     |
| 170   | 92                                  | 5 9       |                                     |
| 171   | 92                                  | 5 9       |                                     |
| 172   | 92                                  | 5 9       |                                     |
| 173   | 92                                  | 5 9       |                                     |

3



cp

Thurs 22<sup>nd</sup> April 1842.

Report Made by Taylor & Taylor  
Schools other than Parish  
in 1842

Schools in town of Thorse besides the Parish School  
Repaired or by Part W.R. Taylor & C. F. Taylor

| Name & description<br>of School | Dimensions of Plot |         |        | Area<br>sq ft | No. of<br>Scholars | No. of<br>Teachers | No. of<br>Pupils | No. of<br>Scholars | No. of<br>Pupils | No. of<br>Pupils | No. of<br>Pupils | No. of<br>Pupils |
|---------------------------------|--------------------|---------|--------|---------------|--------------------|--------------------|------------------|--------------------|------------------|------------------|------------------|------------------|
|                                 | Length             | Breadth | Height |               |                    |                    |                  |                    |                  |                  |                  |                  |
| Free Church School              | 52                 | 19 1/2  | 15     | 1022          | Land               | 200                | 129              | 100                | 100              | 100              | 100              | 2/6              |
| Parish School                   | 43 1/2             | 21 1/2  | 15     | 914           | Land               | 220                | 165              | 160                | 150              | 150              | 150              | 10               |
| Methodist School                | 21 1/2             | 17 1/2  | 15 1/2 | 491           | 2d                 | 100                | 70               | 60                 | 60               | 60               | 60               | 6/8              |
| Private School                  | 16 1/2             | 12 1/2  | 6      | 126           | 2 1/2              | 35                 | 60               | 35                 | 35               | 35               | 35               | 3/4              |
| Ladies School                   | 21 1/2             | 15 1/2  | 8 1/2  | 279           | 2 1/2              | 37                 | 40               | 39                 | 39               | 39               | 39               | 1/2 1/4          |
| 2 <sup>d</sup> High School      | 13                 | 13 1/2  | 14 1/2 | 261           | 2 1/2              | 15                 | 25               | 24                 | 24               | 24               | 24               | 1/2 1/4          |

cp

Report

The Archive staff are on duty to advise users and to guide them towards records which are relevant to their enquiries, and to assist in interpreting the records. Staff are able to answer brief enquiries about the availability of records by post, by email, or by telephone. More extensive research into the collections can be undertaken for a fee (please ask for details).

Surveys of archives held in private or institutional hands can be undertaken, and reports provided.





Advice on the preservation and conservation of documents is available from the staff of the Archive Conservation Unit.

An Education and Outreach service is available from the Archive Service. Visits to the centres can be arranged for school groups, community organisations, and local and family history groups. Exhibitions can be staged at external venues, and the archivists are available to give daytime or evening talks as required.

*Minute of Proceedings at Pultney Harbour in 1864.*

| No | Committee | Kind | Number | Remarks                          |
|----|-----------|------|--------|----------------------------------|
|    |           |      |        | Friday 1 <sup>st</sup> July 1864 |
|    |           |      |        | Light extinguished at 8.20 AM    |
| 1  |           |      |        |                                  |
| 2  |           |      |        |                                  |
| 3  |           |      |        |                                  |
| 4  |           |      |        |                                  |
| 5  |           |      |        |                                  |
| 6  |           |      |        |                                  |
| 7  |           |      |        |                                  |
| 8  |           |      |        |                                  |
| 9  |           |      |        |                                  |
| 10 |           |      |        |                                  |
| 11 |           |      |        |                                  |
| 12 | 29.37     |      |        |                                  |
| 1  |           |      |        |                                  |
| 2  |           |      |        |                                  |
| 3  |           |      |        |                                  |
| 4  |           |      |        |                                  |
| 5  |           |      |        |                                  |
| 6  |           |      |        |                                  |
| 7  |           |      |        |                                  |
| 8  |           |      |        |                                  |
| 9  |           |      |        |                                  |
| 10 |           |      |        |                                  |
| 11 |           |      |        |                                  |
| 12 |           |      |        |                                  |

*Light extinguished at 8.20 AM*

# Highland Archive Centre

Seirbheis Tasglainn na Gàidhealtachd



## SEARCHROOM OPENING HOURS

- Monday 10am - 5pm
  - Tuesday 10am - 5pm
  - Wednesday 10am - 7.30pm
  - Thursday 10am - 5pm
  - Friday Closed
- (the searchroom is available for pre-arranged group visits)





|   |       |
|---|-------|
| Three Berths will be added after 10th September.  |       |
| <b>GOING EAST.</b>  |       |
| Lochmaben   | 10.00 |
| Lochmaben to Glasgow  | 10.00 |
| Lochmaben to Glasgow and Aberdeen   | 10.00 |
| Lochmaben to Glasgow and Aberdeen and London  | 10.00 |
| Lochmaben to Glasgow and Aberdeen and London and Liverpool  | 10.00 |
| Lochmaben to Glasgow and Aberdeen and London and Liverpool and London   | 10.00 |
| Lochmaben to Glasgow and Aberdeen and London and Liverpool and London and London                                  | 10.00 |
| Lochmaben to Glasgow and Aberdeen and London and Liverpool and London and London and London                       | 10.00 |
| Lochmaben to Glasgow and Aberdeen and London and Liverpool and London and London and London and London            | 10.00 |
| Lochmaben to Glasgow and Aberdeen and London and Liverpool and London and London and London and London and London | 10.00 |

## Time Table and Fare List

**DAVID MACBRAYNE, Ltd.**



*RMS Caledonia*

### ROYAL MAIL STEAMERS

000

## The Caledonian Canal.

|   |       |
|---|-------|
| Three Berths will be added after 10th September.  |       |
| <b>GOING WEST.</b>  |       |
| Lochmaben   | 10.00 |
| Lochmaben to Glasgow  | 10.00 |
| Lochmaben to Glasgow and Aberdeen   | 10.00 |
| Lochmaben to Glasgow and Aberdeen and London  | 10.00 |
| Lochmaben to Glasgow and Aberdeen and London and Liverpool  | 10.00 |
| Lochmaben to Glasgow and Aberdeen and London and Liverpool and London   | 10.00 |
| Lochmaben to Glasgow and Aberdeen and London and Liverpool and London and London                                  | 10.00 |
| Lochmaben to Glasgow and Aberdeen and London and Liverpool and London and London and London                       | 10.00 |
| Lochmaben to Glasgow and Aberdeen and London and Liverpool and London and London and London and London            | 10.00 |
| Lochmaben to Glasgow and Aberdeen and London and Liverpool and London and London and London and London and London | 10.00 |

The archives in the care of The Highland Archive Centre date from the 14<sup>th</sup> century to the present day, and consist of documents in different formats from charters, minute books, correspondence and accounts, to maps, photographs, and films. With certain exceptions these may be consulted free of charge in the public searchroom.

The main series of official records held at The Highland Archive Centre are those created by The Highland Council and its predecessors, the former Regional, District, County, and Burgh Councils:

- ◆ The Counties of Inverness, Nairn, Ross and Cromarty, and Sutherland from the 18<sup>th</sup> century to 1975. (NB records of the County of Caithness are held at the Caithness Archive Centre, Wick.)





- ◆ The Burghs of Cromarty, Dingwall, Dornoch, Fortrose, Grantown on Spey, Invergordon, Inverness, Kingussie, Nairn and Tain from the 14<sup>th</sup> century to 1975. *(NB records of the Burghs of Fort William, Thurso and Wick are held at the Area Archive Centres in Lochaber and Caithness as appropriate.)*

- ◆ The Highland Regional Council, 1975-1996.

The records of local government administration include:

- ◆ Education records from the 1860s, including logbooks and admission registers for more than three hundred schools.
- ◆ Poor relief records, 1845-1929.
- ◆ Records of Highway Authorities, including Turnpike Trusts, 1804-1890.
- ◆ Property valuation rolls, 1868-1989.
- ◆ Dean of Guild and Building Control plans and registers, 1890-1975.
- ◆ Inverness Burgh records include High Court and Inverness County Sheriff Court process papers, 17<sup>th</sup> – 19<sup>th</sup> Century.
- ◆ Abridgements of Sasines for the Counties of Argyll, Caithness, Inverness, Nairn, Ross and Cromarty and Sutherland from 1781.
- ◆ Police archives, 1858-1992.

Among the many hundreds of privately deposited archives in the care of Highland Archives there are:

- ◆ Highland Health Board archives, dating from 1798.
- ◆ Estate and family papers.
- ◆ Business and industrial records.
- ◆ Church records including kirk session records for parishes in the presbyteries of Inverness, Ross, Sutherland, Lochcarron-Skye, and part of Moray, dating from the 1640s.
- ◆ Records of societies, and other local organisations.
- ◆ Records relating to the history of tartan.
- ◆ Maps and plans, including estate maps, Roy's Military Survey, and extensive holdings of 25": 1 mile scale Ordnance Survey plans dating from the 1860s.

#### **NB**

Records relating to **Caithness** are held at the Caithness Archive Centre, Wick. Records relating to **Lochaber** are held at the Lochaber Archive Centre, Fort William. Records relating to **Skye and Lochalsh** are held at the Skye and Lochalsh Archive Centre, Portree.



# The Family History Centre

## Ionad Eachdraidh Teaghlach



An integral part of the Highland Archive Centre, is the Family History Centre, a facility dedicated to all aspects of genealogy, clan history, and family history throughout the Highlands and the wider world.

### FAMILY HISTORY CENTRE OPENING HOURS

Monday 10am - 5pm  
 Tuesday 10am - 5pm  
 Wednesday 10am - 7.30pm  
 Thursday 10am - 5pm  
 Friday 10am - 5pm

#### VALUATION ROLL of the COUNTY of ROSS for Year 1872-73.—PARISH of LOCHCARRON.

| No.  | Description and Situation of Subject.  | Proprietor.  | Tenant or Occupier.             | Duration of Lease. | Val. Ad. |
|------|--|--|---------------------------------|--------------------|----------|
| 2148 | Land, Coullags ... ..  | Sir Ivor Bertie Guest, Bart.   | Widow Farquhar Maclellan ... .. | ...                | ...      |
| 2149 | " ditto ... ..   | ... ditto ... ..   | Duncan Maclellan ... ..         | ...                | ...      |
| 2150 | " ditto ... ..   | ... ditto ... ..   | Widow D. Macdonald, sen. ... .. | ...                | ...      |
| 2151 | " ditto ... ..   | ... ditto ... ..   | Widow D. Macdonald, jun. ... .. | ...                | ...      |
| 2152 | " ditto ... ..   | ... ditto ... ..   | Widow Donald Macrae ... ..      | ...                | ...      |
| 2153 | " ditto ... ..   | ... ditto ... ..   | Murilo Maclean ... ..           | ...                | ...      |
| 2154 | " ditto ... ..   | ... ditto ... ..   | Alexander Maclean ... ..        | ...                | ...      |
| 2155 | House, &c., Achmashellach ... ..   | ... ditto ... ..   | Proprietor ... ..               | ...                | ...      |
| 2156 | Deer Forest, part of Corrieveinnie, Corrielerie, Comras, Craignellan, Gortan, Lair, Craig, part of Hill of Balnacra and Achmashellach ... .. | ... ditto ... ..   | ditto ... ..                    | ...                | ...      |
| 2157 | Fishings, Carron and Loch Doule ... ..   | ... ditto ... ..   | ditto ... ..                    | ...                | ...      |
| 2158 | Land, Morusk, and part of Corrieveinnie and Corrielerie ... ..   | John R. Shaw of Glencarron, Arrow Park, Birkenhead ... ..                                    | Robert Tennant ... ..           | ...                | 14       |
| 2159 | Loanorrieschrubie ... ..   | ... ditto ... ..   | Alexander Chisholm ... ..       | ...                | ...      |
| 2160 | Fishings, West Corrieveinnie ... ..  | ... ditto ... ..   | Proprietor ... ..               | ...                | ...      |
| 2161 | Lodge, Glencarron ... ..   | ... ditto ... ..   | ditto ... ..                    | ...                | ...      |
| 2162 | House, Strathcarron ... ..   | The Dingwall and Skye Railway Company, per Charles Lamond, Railway Offices, Inverness ... .. | J. Junner, porter ... ..        | ...                | ...      |
| 2163 | Coulin Lodge, and Forest Grazings ... ..   | Right Hon. Lord Elphinstone, per Thomas Lees, Musselburgh ... ..                             | Proprietor ... ..               | ...                | ...      |
| 2164 | Fishings ... ..  | ... ditto ... ..   | ditto ... ..                    | ...                | ...      |
| 2165 | Established Manse and Garden, Lochcarron ... ..  | Rev. John Haggart ... ..   | ditto ... ..                    | ...                | ...      |
| 2166 | " Glebe Lands ... ..   | ... ditto ... ..   | Roderick Mackenzie ... ..       | ...                | ...      |
| 2167 | " Church Manse ... ..  | Rev. Donald Forbes ... ..  | Proprietor ... ..               | ...                | 999      |

The Highland Genealogy Service holds and makes available extensive holdings of material which may be of assistance to the family historian, and, in addition the genealogy staff are able to offer general advice, answer enquiries, and undertake more detailed research and consultations when these are required.

A leaflet giving details of sources available at the Family History Centre may be requested. Please ask for a copy.

*Prior to visiting the Family History Centre we recommend, where possible, that you collect any information available from within your family and bring it with you, for example birth, marriage and death certificates, the family Bible if available, and also any information which may have come down in your family through the oral tradition.*

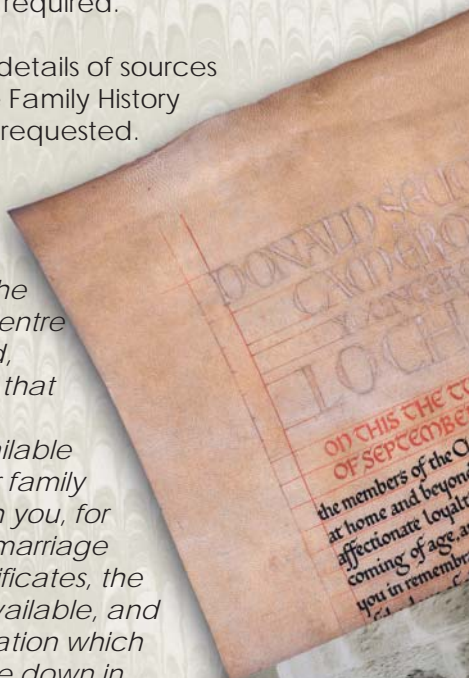

# Caithness Archive Centre Tasglann Ghallaibh



## OPENING HOURS

|           |                           |
|-----------|---------------------------|
| Monday    | 10am - 1pm & 2pm - 5.30pm |
| Tuesday   | 10am - 1pm & 2pm - 5.30pm |
| Wednesday | Closed                    |
| Thursday  | 10am - 1pm & 2pm - 5.30pm |
| Friday    | 10am - 1pm & 2pm - 5pm    |



As part of the Highland Archive Service, the Caithness Archive Centre at Wick is responsible for locating, preserving and making accessible documents relating to all aspects of Highland history.

The Caithness Archive Centre collects and preserves archives relating to Caithness, dating from 1589 to the present, and, with certain exceptions, these may be consulted free of charge, in the public searchroom.



The archives in the care of the Caithness Archive Centre date from the 16<sup>th</sup> century to the present, and consist of documents in different formats including charters, minute books, correspondence, maps, plans, photographs and films.

### Collections held at the Caithness Archive Centre include:

#### Cruinneachaidhean a th' aig Tasglann Ghallaibh

- ◆ Caithness County Council records, 1890-1975.
- ◆ Education records from the 1860s, including logbooks and admission registers from more than sixty Caithness schools.
- ◆ Poor relief records, 1845-1930.

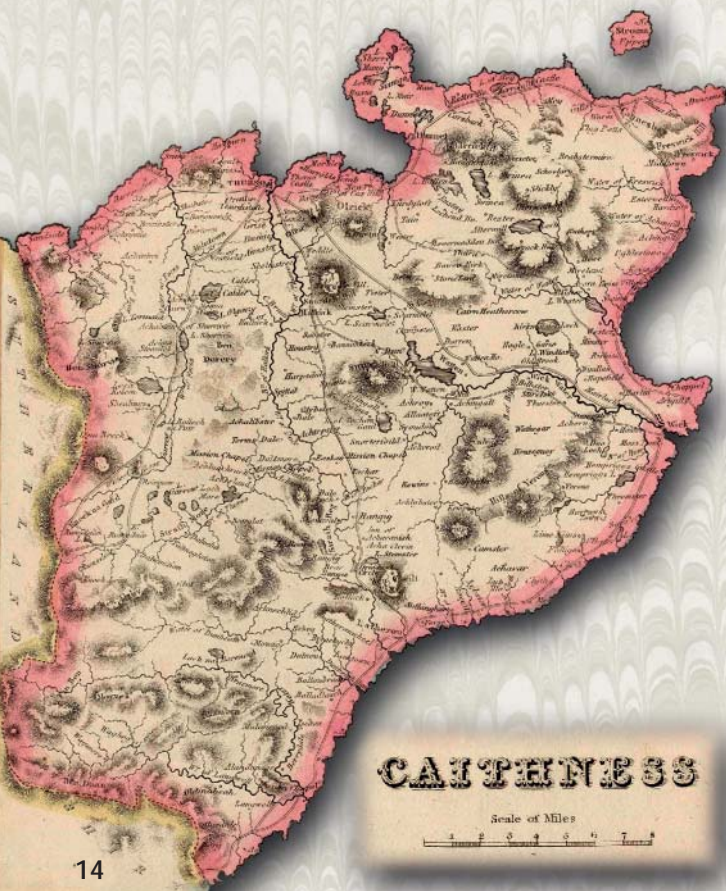



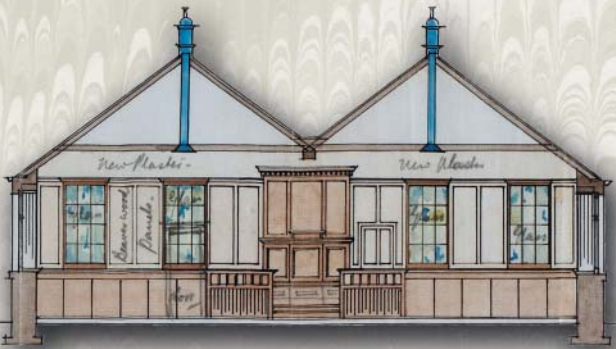

- ◆ Property valuation rolls, 1878-1975.
- ◆ Thurso Burgh records, 1803-1965.
- ◆ Wick Burgh records, 1589-1975.
- ◆ Police records, 1858-2002.
- ◆ Wick Customs and Excise records, 1855-1989.
- ◆ Records of Wick Harbour Trust, 1880-1988, and Thurso River Harbour Trust, 1889-1971.
- ◆ Abridgements of Sasines for the County of Caithness from 1781.
- ◆ Business records.
- ◆ Records of individuals, societies and other organisations.
- ◆ Maps and plans, including Ordnance Survey plans scale 25":1 mile, dating from 1870.
- ◆ Genealogical resources on microfilm for the counties of Caithness and Sutherland including census returns, Old Parish Registers, and the International Genealogical Index.



THURSO CASTLE.  
CAITHNESS.

# Lochaber Archive Centre Tasglann Loch Abar

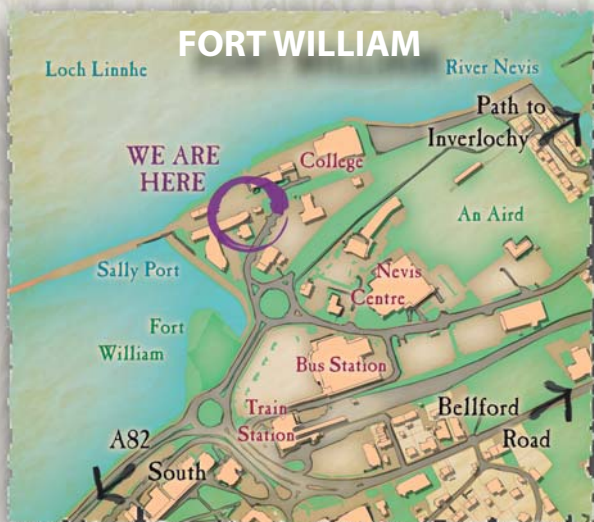

## OPENING HOURS

|           |   |
|-----------|---|
| Monday    | 10am - 1pm & 2pm - 5pm<br>(5pm - 7.30pm by appointment) |
| Tuesday   | 10am - 1pm & 2pm - 5pm                                  |
| Wednesday | Closed  |
| Thursday  | 10am - 1pm & 2pm - 5pm                                  |
| Friday    | 10am - 1pm & 2pm - 5pm                                  |

*Parking is available at West Highland College, and refreshments may be purchased in the College café.*





THE FORTS AND BARRACKS TO THE CALDONIAN CANAL.

Summer 1844

As part of the Highland Archive Service, the Lochaber Archive Centre at Fort William is responsible for locating, preserving and making accessible documents relating to all aspects of Highland history.

The Lochaber Archive Centre collects and preserves archives relating to Lochaber, dating from the 17<sup>th</sup> century to the present, and, with certain exceptions, these may be consulted free of charge in the public searchroom.

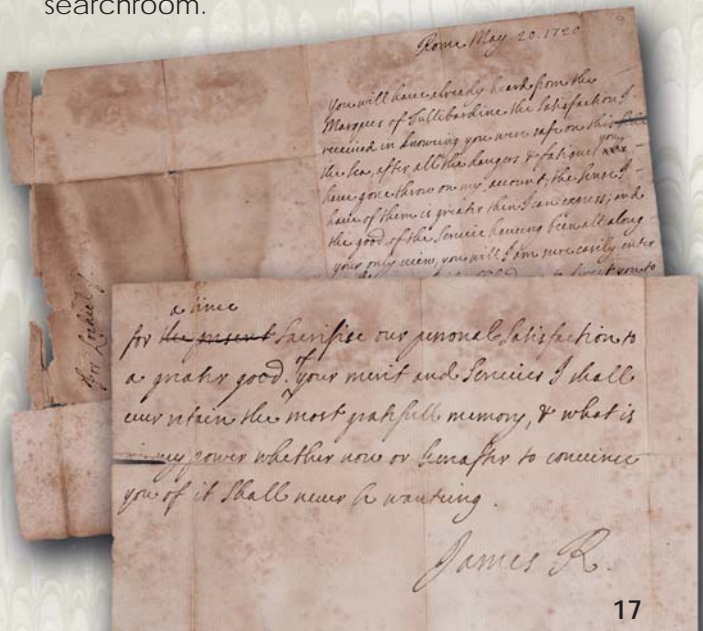

Rome, May 20. 1750

You will have already heard from the  
 Marquis of Sallaburgh, the satisfaction  
 received in knowing you were safe on this  
 the sea, after all the dangers & fatigues  
 have gone thro' on my account; the sense  
 that of them is greater than I can express; and  
 the good of the Service having been all along  
 your only view, you will I am sure, easily enter  
 into my sentiments.

For Lochaber

since  
 for the present sacrifice our personal satisfaction to  
 a greater good. Your merit and Services I shall  
 ever retain the most grateful memory, & what is  
 my power whether now or hereafter to convince  
 you of it shall never be wanting.

James R.

The archives in the care of the Lochaber Archive Centre consist of documents in different formats including charters, minute books, correspondence, maps, plans, photographs and films.

**Collections held at the Lochaber Archive Centre include:**

**Na Cruinneachaidhean a tha aig Tasglann Loch Abar:**

- ◆ Local authority records created by the former Counties of Inverness and Argyll which relate to the Lochaber area, 1890-1975.
- ◆ Education records from the 1860s, including logbooks and admission registers from more than sixty Lochaber schools.
- ◆ Poor relief records, 1845-1930.
- ◆ Property valuation rolls, 1874-1990.
- ◆ Fort William Burgh records, 1874-1975.
- ◆ Police archives, 1875-1946.
- ◆ Church records including kirk session and presbytery records for parishes in the Lochaber Presbytery, 1724-1991.

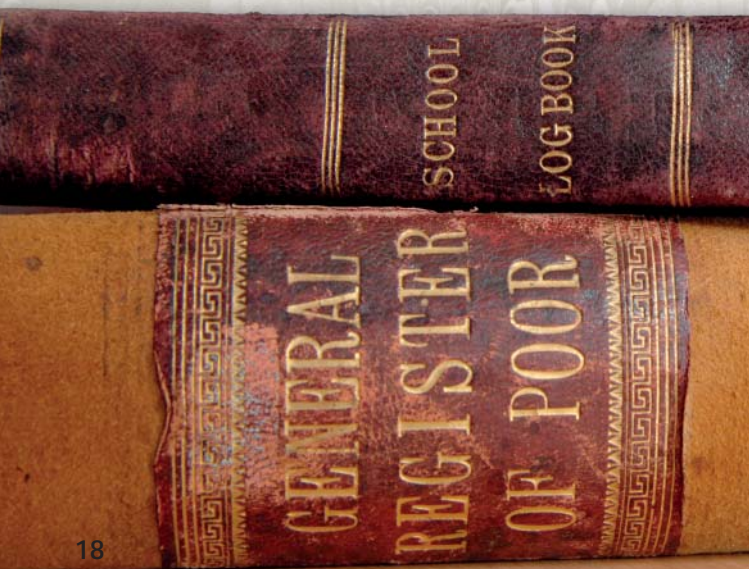

heard Donald McMillan residing in Blaik, and  
at McLaughlin residing in Acahaphuil Ardgoon,  
found guilty, in terms of their own Confession,  
of Fornication, and being rebuked before the  
congregation for the second time, the Session agree to  
exclude them from the census of the Church, upon their settling  
the Treasurers of the Poor Fund by paying the  
fine of £4.13.4. — Closed with prayers.  
Thomas Davidson Moderator

At the Church of Kilmartin, the 24<sup>th</sup> day of  
1836. The Kirk Session being met and constituted.  
Present — Rev. Thomas Davidson Moderator, and Messrs  
Gordon Cameron, Alexander Ross, Alexander Fraser  
Donald Cameron Elders. — The Kirk Session deeply  
regretting the existing custom of presenting immoderate quan-  
tities of ardent spirits at Funerals throughout many parts of  
the Highlands, and in this Parish among others, and sensible  
that this unhappy practice is fortified by the prejudices, and  
false notions of the great body of the people, and that  
the consequent evils of intemperance and riots which  
too —

- ◆ Abridgements of Sasines for the Counties of Argyll and Inverness, from 1781.
- ◆ Estate and family papers including those of Cameron of Lochiel from 1679, Cameron-Head of Inverailort, from 1799, the MacColl Papers from 1811 and the Thom of Canna Papers from 1865.
- ◆ Archives of individuals, businesses, societies, and other organisations.
- ◆ Maps and plans, including Ordnance Survey plans scale 25":1 mile dating from 1870.
- ◆ Genealogical resources on microfilm for the Lochaber area including census returns, 1841-1901, Old Parish Registers, and the International Genealogical Index.

Skye and Lochalsh Archive Centre  
Ionad Tasglainn an  
Eilein Sgitheanaich is Loch Aillse



**OPENING HOURS**

|           |                        |
|-----------|------------------------|
| Monday    | 10am - 1pm & 2pm - 5pm |
| Tuesday   | 10am - 1pm & 2pm - 5pm |
| Wednesday | Closed                 |
| Thursday  | 10am - 1pm & 2pm - 5pm |
| Friday    | 10am - 1pm & 2pm - 5pm |

Other times may be possible  
by arrangement.





As part of the Highland Archive Service, the Skye and Lochalsh Archive Centre at Portree is responsible for locating, preserving and making accessible documents relating to all aspects of Highland history.

The Skye and Lochalsh Archive Centre collects and preserves archives relating to the local area dating from the 17<sup>th</sup> century to the present, and with certain exceptions, these may be consulted free of charge in the public searchroom.



The archives in the care of the Skye and Lochalsh Archive Centre consist of documents in different formats including maps, plans, photographs, drawings and sound recordings.

**Collections held at the Skye and Lochalsh Archive Centre include:**

**Na Cruinneachaidhean a tha aig Tasglann an Eilein Sgitheanaich agus Loch Aillse:**

- ◆ Local authority records created by the former Counties of Inverness and Ross and Cromarty which relate to the Skye and Lochalsh area, 1854-1975.
- ◆ Education records from the 1860s, including logbooks and admission registers for many Skye and Lochalsh schools.
- ◆ Poor relief records, 1856-1929.
- ◆ Property valuation rolls, 1874-1975.

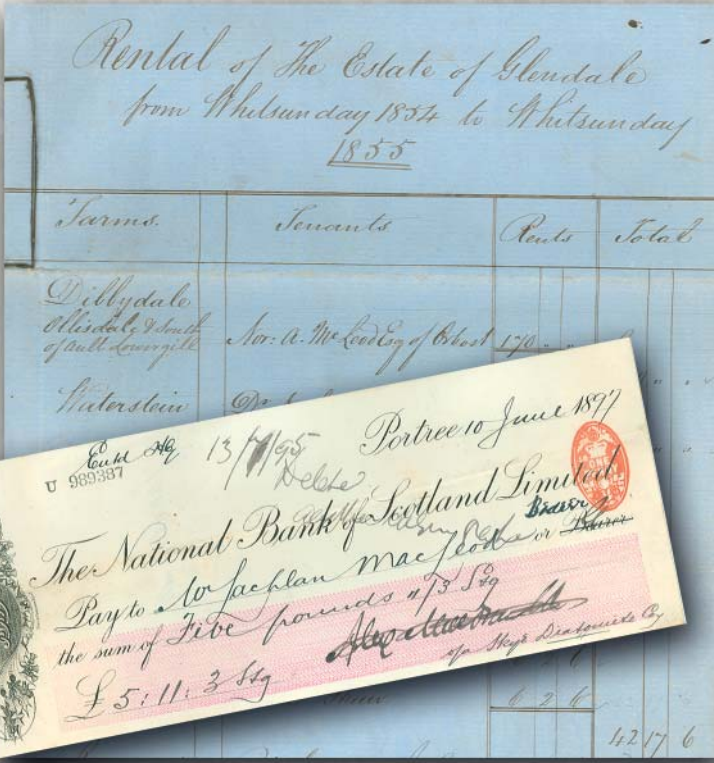





- ◆ Police archives, 1877-1994.
- ◆ Abridgements of Sasines for the Counties of Inverness and Ross and Cromarty from 1821.
- ◆ Estate and family papers.
- ◆ Business records.
- ◆ Records of individuals, societies and other organisations.
- ◆ Maps and plans, including early Ordnance Survey maps.
- ◆ Local newspapers: *Clarion of Skye*, 1950-1957; *West Highland Free Press*, 1972-present.
- ◆ Photographs.
- ◆ Prints and drawings.
- ◆ Genealogical resources on microfilm: census returns for Skye and Lochalsh parishes, 1841-1901; Old Parish Registers for Skye and Outer Hebrides, 1800-1854.
- ◆ Extensive local history library.

# RECORD OF PERSONS DETAINED IN CUSTODY

| No.  | NAME.              | AGE. | CRIME OR OFFENCE. | BY WHOM APPREHENDED. | TIME.  |       | DETAINED. |         | HOW DISPOSED OF.            |
|------|--------------------|------|-------------------|----------------------|--------|-------|-----------|---------|-----------------------------|
|      |                    |      |                   |                      | Date.  | Hour. | To        | Hour.   |                             |
| 1888 |                    |      |                   |                      |        |       |           |         |                             |
| 53   | Peter MacKeay      | 21   | "                 | P. J. J. Macaulay    | Nov 24 | 9 pm  | Dec 25    | 9 am    | 12 <sup>S</sup> Reported in |
| 54   | William MacKeay    | 21   | "                 | "                    | Dec 10 | 8 pm  | Nov 29    | 12 noon | Reported                    |
| 55   | Edonald Williamson | 48   | "                 | "                    | "      | 12 pm | Dec 11    | 11 pm   | 16 Reported in              |
| 56   | Mary Williamson    | "    | "                 | "                    | "      | 12 pm | "         | "       | "                           |
| 57   | Amie Macdonald     | "    | "                 | "                    | "      | 12 pm | "         | "       | "                           |
| 58   | Barbara MacKeay    | "    | "                 | "                    | "      | 12 pm | "         | "       | "                           |
|      | William MacKeay    |      |                   | P. J. J. Macaulay    |        |       |           |         |                             |
|      |                    |      |                   |                      |        |       |           |         |                             |
|      |                    |      |                   |                      |        |       |           |         |                             |
|      |                    |      |                   |                      |        |       |           |         |                             |
|      |                    |      |                   |                      |        |       |           |         |                             |
|      |                    |      |                   |                      |        |       |           |         |                             |
|      |                    |      |                   |                      |        |       |           |         |                             |
|      |                    |      |                   |                      |        |       |           |         |                             |
|      |                    |      |                   |                      |        |       |           |         |                             |
|      |                    |      |                   |                      |        |       |           |         |                             |

**PAGE DESCRIPTION**

- Front Charter relating to privileges granted to the Burgh of Fortrose, 1455.
- 2 Engraving of Inverness, c.1770  
Nairn Parish Church, Dean of Guild plan, 1893.
- 3 Digging a train out of snow at Altnabreac, Caithness, c.1898.  
Sutherland Education Authority dux medal.  
Rosehall School admission register, 1891.
- 4 Thurso School Board minutes, 1872.
- 5 Harris Tweed label.  
Wick Harbour Trust, Harbourmaster's diary, 1864.
- 7 Caledonian Canal timetable, 1908.  
Nairn Fishermen's Society minute book, 1767.
- 9 Detail from HMI Inspector of Schools presentation album, 1905.
- 10 St.Kilda children, c.1905.  
County of Ross valuation roll, 1872-73.
- 11 Loyal address to Donald Seamus Cameron, Younger of Lochiel, from the Clan Cameron Association on his coming of age, 1931.  
Embo school photograph, 1912.
- 13 Wick Burgh Charter, 1589.  
Highland railway staff at Wick, c.1875.
- 14 Map of the County of Caithness, 1828.
- 15 Sinclair MacDonald & Son, architect's plan for alterations to Dunnet United Free Church, 1920.  
Engraving of Thurso Castle, c.1840.
- 17 Engraving of Ben Nevis and the entrance to the Caledonian Canal, c.1840.  
Letter from James Edward Stuart in Rome to Cameron of Lochiel, 1720.
- 19 Kirk Session of Kilmallie 1836.
- 21 Reconstruction of Caisteal Maol, Kyleakin, by David L. Roberts, 1995.
- 21 Sketch Plan for Ross Memorial Hospital, Portree, 1891.
- 22 Extract from Glendale Estate Rental 1854-55.
- 22 Cheque signed by Alexander Macdonald on behalf of the Skye Diatomite Company, 1897.
- 23 Dornie, early 20th century, Duncan Macpherson Collection.
- 23 At the Pier, Kyle of Lochalsh, 1930s, Duncan Macpherson Collection.
- 24 Thurso Police Station, Record of Persons in Custody, 1888.
- Back Engraving of Loch Assynt and Ardvreck Castle, c.1840.



*Loch Assynt & Inverness Castle*

For further information or to request this information in an alternative format e.g. large print, braille, computer disk, audio tape, or suitable language, please contact:

**HIGHLAND ARCHIVE AND CENTRE**

Bught Road, Inverness IV3 5SS

Telephone: 01463 256444

Email: [archives@highlifehighland.com](mailto:archives@highlifehighland.com)

[www.highlandarchives.org.uk](http://www.highlandarchives.org.uk)



High Life Highland is a company limited by guarantee registered in Scotland No. SC407011 and is a registered Scottish charity No. SC042593

This version PR12- 209 - k - December 2012

Designed by Karen Sutherland . Public Relations Office . The Highland Council  
Location maps © Crown Copyright 100023369 2009

